

The Dorset Council Local Plan

Local Plan Options Consultation is now live, and runs until 15 March 2021. Please use the button below to view a full version of the plan, and submit your comments. There are alternative ways someone can comment on the plan.

[Comment on The Dorset Council Local Plan](#)

[Dorset Council Local Plan](#) | [Evidence](#) | [Background papers](#) | [Consultation](#)

Evidence
Evidence relating to The Dorset Council Local Plan

Background papers
Background papers relating to The Dorset Council Local Plan

Consultation
Links, podcasts, consultation relating to the plan

By continuing to use this site and closing this message you agree to our use of cookies [Find out more](#)

[https://
www.dorsetcouncil.gov.uk/
planning-buildings-land/
planning-policy/dorset-
council-local-plan.aspx](https://www.dorsetcouncil.gov.uk/planning-buildings-land/planning-policy/dorset-council-local-plan.aspx)

[Home](#) [Services](#)

Dorset Council Local Plan consultation

[Main menu](#)

Welcome to the Dorset Council Local Plan consultation

You will be able to comment or view the consultation between 18 January and 15 March 2021. You will need to register with us with your name, email or postal address in order to submit your comments. Your details will not be shared and will be asked again.

We have designed the web-form with questions enabling you to comment on the plan. You will receive a confirmation of your response each time you complete a question, and you may comment on the plan as many times as you like. You may navigate to the various sections of the plan.

If your comments are particularly long or are being prepared in draft form, it is recommended that you save your comments (for example in word processing software) and copy and paste final versions into the form. Draft comments cannot be saved in the form and later edited.

Would you like to view or comment on the Dorset Council Local Plan?

[View](#) [View and Comment](#)

Click on
[View & Comment](#)

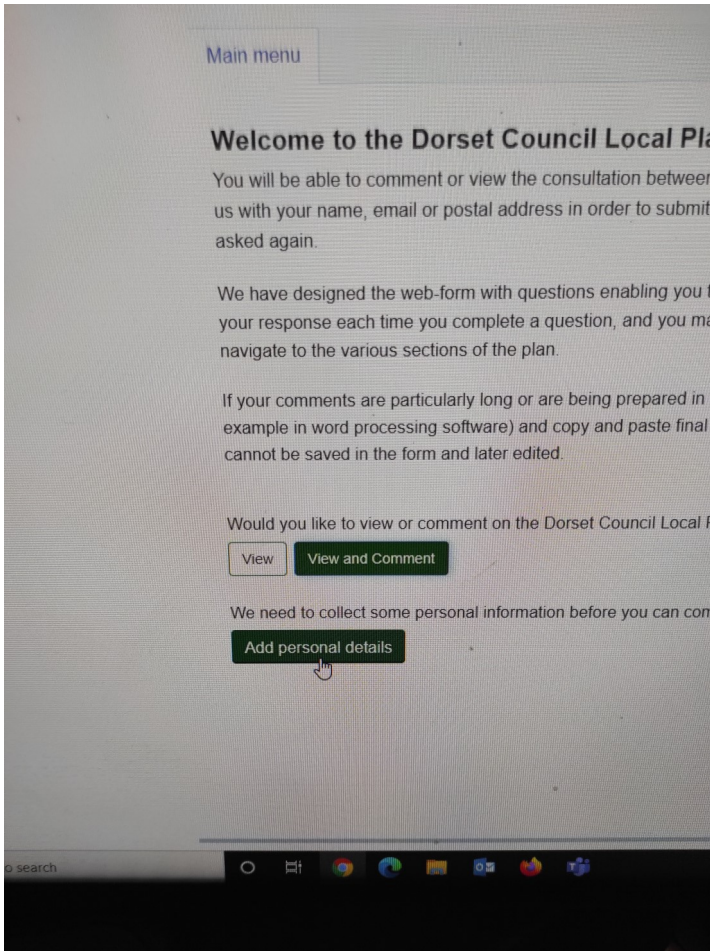

Click

Add Personal Details

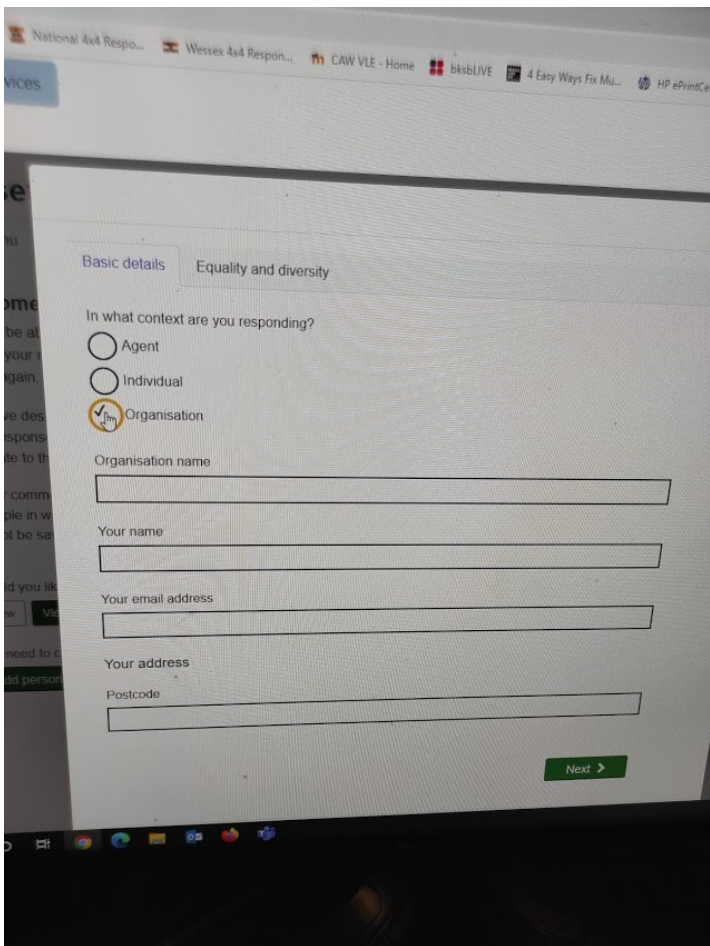

Complete as an

Individual, unless you
are representing an
organisation.

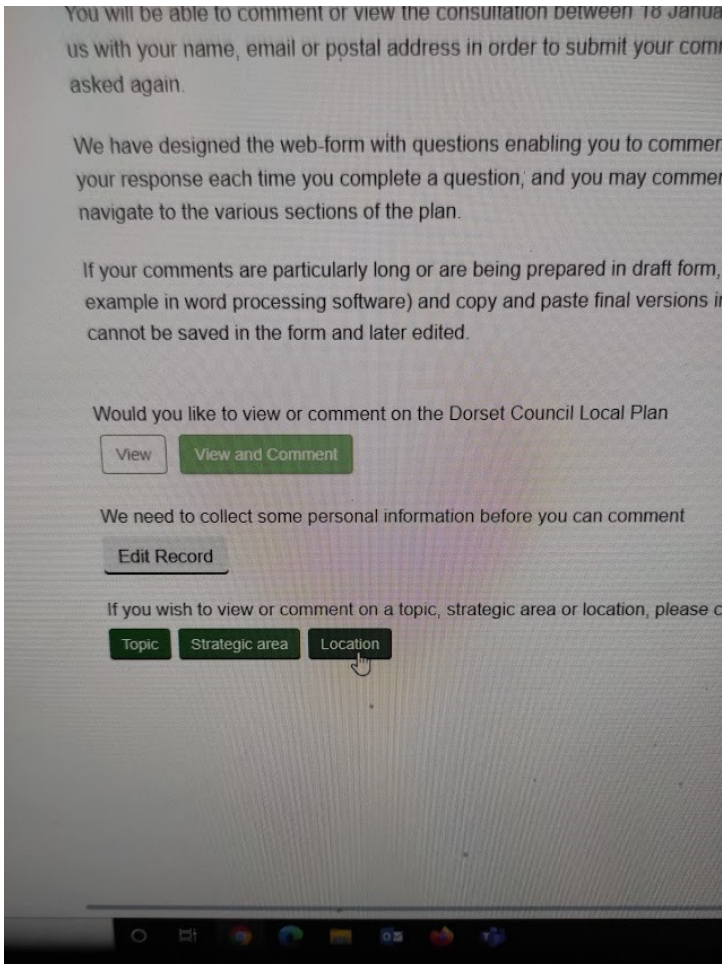

Click
Location

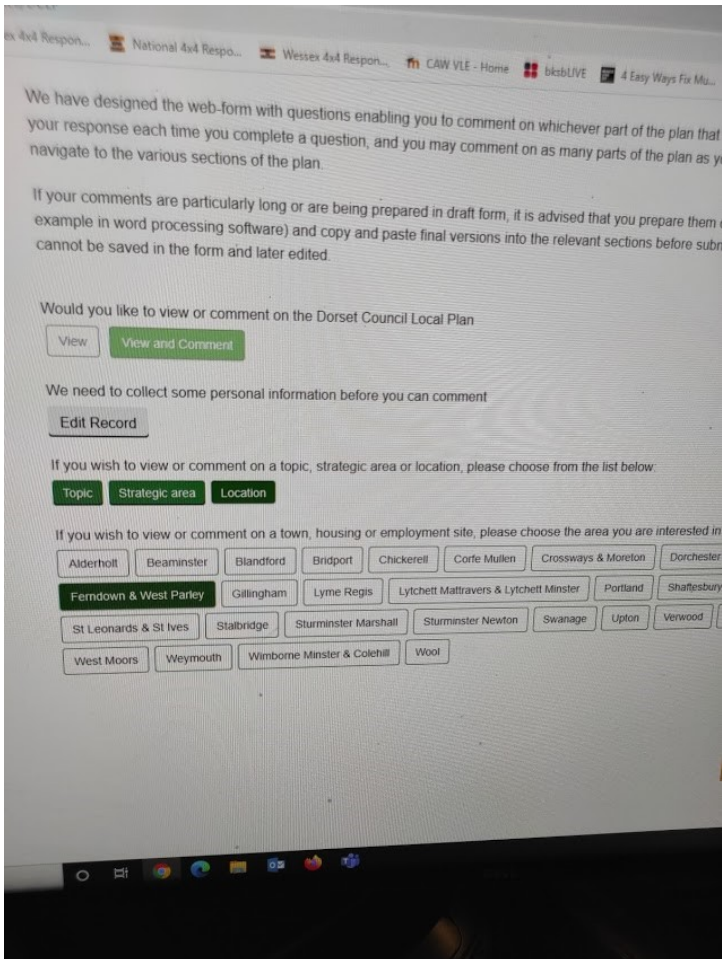

Select
Ferndown and
West Parley

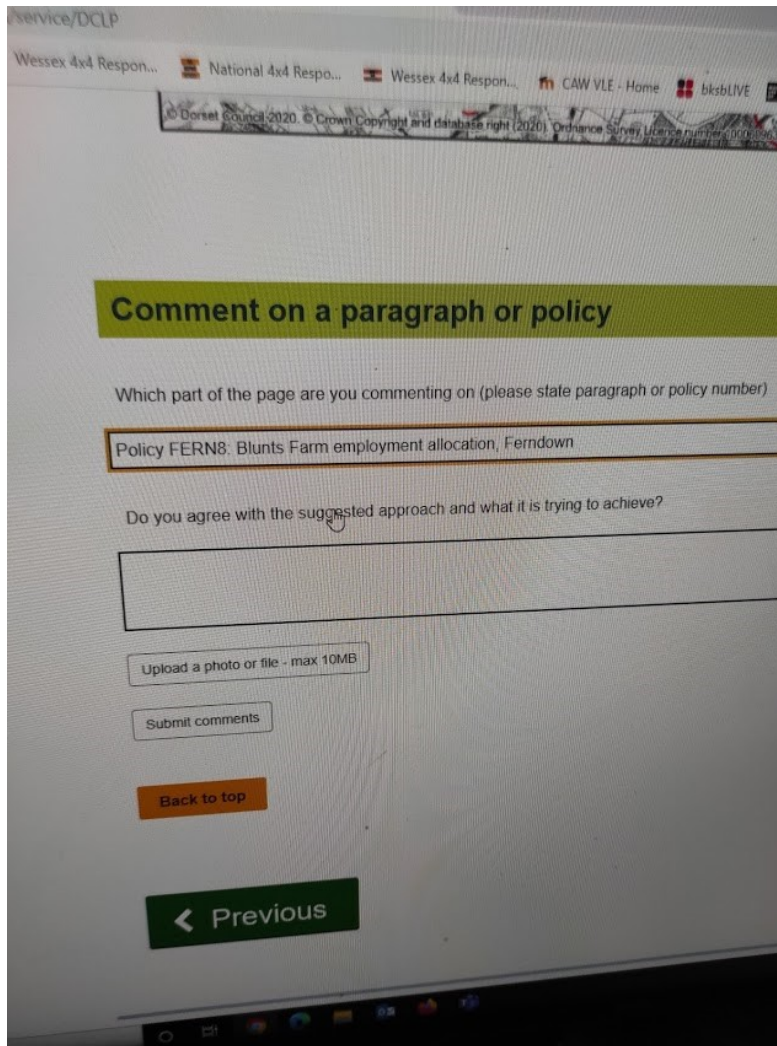

Scroll down.

You will note that -

Policy FERN8: Blunts Farm employment allocation, Ferndown

Does not allow commenting for some reason.....

Scroll to the bottom of the page and you will see a general comment box.

Make it clear it is FERN8 that your comments refer to.

Our views and further help here -

<http://www.cannonhillfriends.org.uk/localplan.html>